

All-Around Choice for Tube-to-Tube or Pipe-to-Pipe Welding

MH115 & MH170

Highly flexible, the MH series GTAW (TIG) weld heads can be used to weld tubing and pipework in a variety of industries.

These open frame, adjustable, weld heads accommodate outside diameters ranging from 1" to 6.625" (25 mm - 170 mm). The weld heads can also operate with or without wire feed.

The many design benefits include:

- a three jawed chuck with replaceable clamshells to ensure a secure fit with a high degree of clamping accuracy,
- a quick release feature that permits fast mount and dismount from the work,
- cross seam and vertical torch height adjusters that can be manually adjusted during welding, and
- an adjustable torch angle allowing flange and socket welds to be carried out simply and effectively.

The MH series of weld heads is also designed for excellent reliability thanks to a simplified design and minimal spare parts.



Weld Quality Starts in the Arc

USA | tel: 1-704-230-2510 | dimmktg@dimetrics.com
INTERNATIONAL | tel: 1-905-689-0734 | liburdi@liburdi.com
EUROPE | tel: +31-6-2036-1018 | liburdieurope@liburdi.com
www.liburdi.com

MH115 & MH170

Standard Features

- Flexible weld diameter range
- Used with tube and pipe applications with and without wire
- High degree of clamping accuracy
- Quick release weld head design for fast mount and dismount
- Adjustable torch position during welding
- Adjustable torch angle for flange and socket welds
- Designed for performance reliability and minimal spare parts.

A = Overall Head Length
 B = Overall Basic Head Width (Diameter of Top Plate)
 C = Diameter of Clearance Hole in Top Plate
 D = Minimum Clearance Radius
 E = Minimum Height

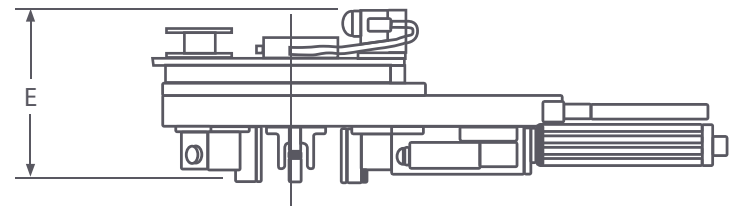
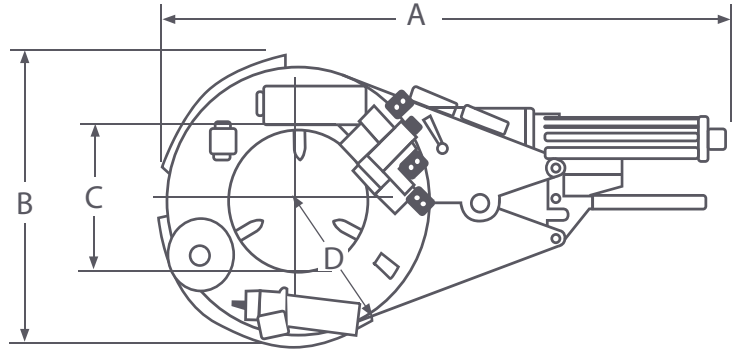

Physical Characteristics

MH - 115 TACH:		MH - 170 TACH:
17-7/8 in (454 mm)	A	20-1/2 in (515 mm)
8 in (203 mm)	B	11-1/2 in (292 mm)
4-11/16 in (119 mm)	C	7-1/4 in (184 mm)
5-1/2 in min.	D	Depends on wire feed
6-3/4 in min.	E	6-1/2 in. Depending on wire feed

MH-115

Maximum Clamping size: 4.5 in. (115 mm)
 Minimum Clamping size: 1.0 in. (25.4 mm)

Jaw Sets:

- D - 0.188 in. (4.8 mm)
- F - 0.688 in. (17.5 mm)
- H - 1.250 in. (31.8 mm)
- J - 1.812 in. (46.0 mm)

Travel Speed

MH115
 6-7.5 RPM

MH170
 5 RPM

Torch Characteristics

Torch Adjustment Range: 0° to 45°
 Electrode: 3/32" Tungsten (standard)
 Radial Adjustment
 (with roller follower): MH115 - 1/2" (13mm);
 MH170 - 1/4" (6mm)
 Axial Adjustment: 1/2" (13mm)
 Current Rating: 200 Amps @ 60% Duty Cycle

Wire Feed Characteristics

MH - 115 (optional) MH - 170 (standard)

Spool Size: 2.5" (64mm) diameter with 1" (25mm) hub
 Wire Diameter: 0.035" (0.89mm) steel wire
 Wire Feed Rates:

Voltage	Rate (per minute)
24 volts	33" (838mm)
12 volts	14" (356mm)
6 volts	5" (127mm)



With up to 300 Amps of welding current and a multi-servo computer controller, Liburdi Dimetrics' P300™ GTAW Portable Welding System is ideal for those demanding Tube and Pipe applications.

© Liburdi Dimetrics Corp. October 26, 2011. Specs subject to change



Weld Quality Starts in the Arc

USA | tel: 1-704-230-2510 | dimmktg@dimetrics.com
 INTERNATIONAL | tel: 1-905-689-0734 | liburdi@liburdi.com
 EUROPE | tel: +31-6-2036-1018 | liburdieurope@liburdi.com
www.liburdi.com